

PRODEMAND

YMMS: 2016 Cadillac ATS V

Engine: 3.6L Eng

VIN:

Feb 25, 2021

License:

Odometer:

Shift Control Assembly Replacement (MG9)

Removal Procedure

1. Remove the shift control knob (1). Transmission Control Lever Knob Replacement

Fig 2: Transmission Control Lever Boot

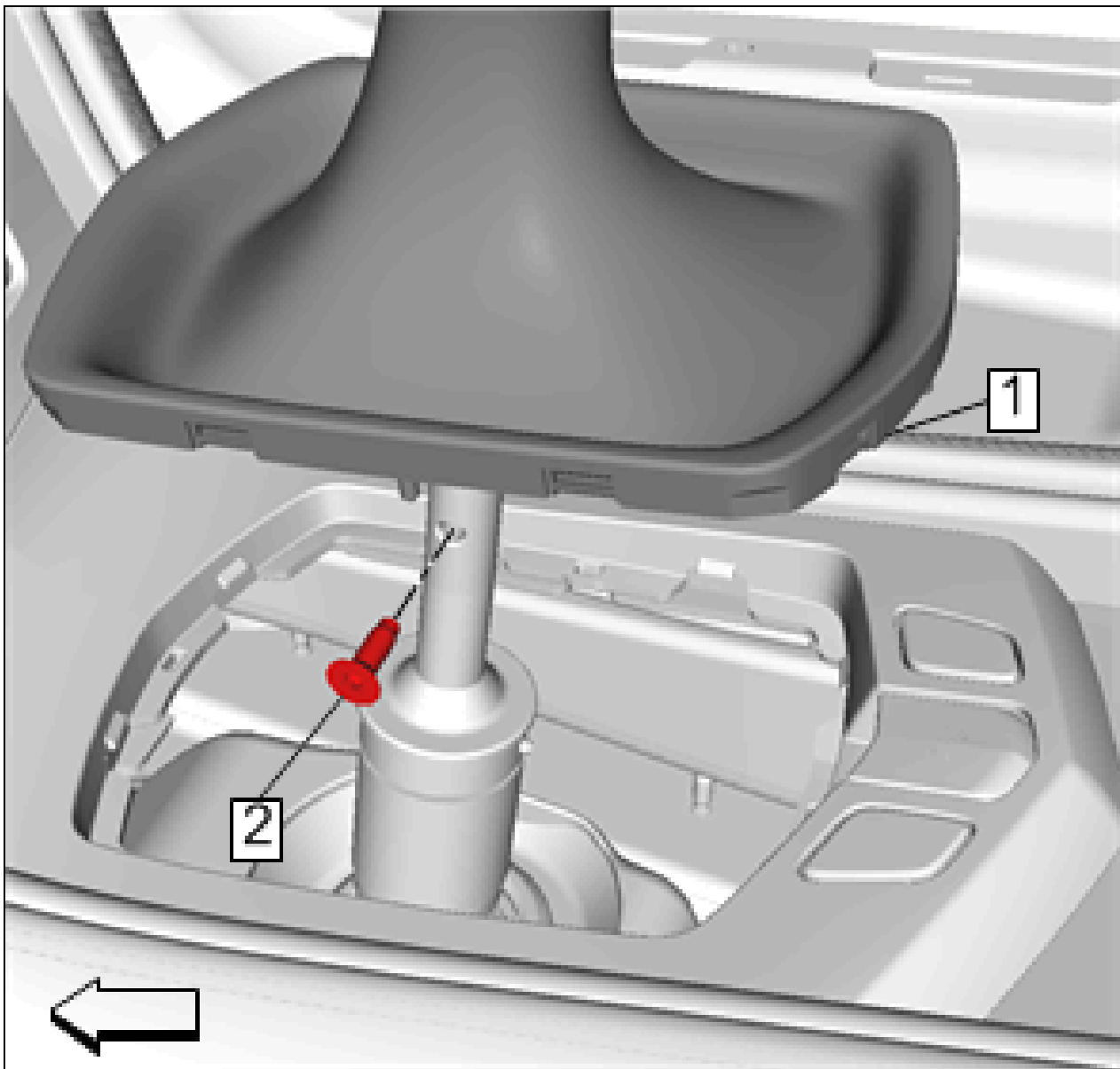

Courtesy of GENERAL MOTORS COMPANY

2. Place the shifter in the Neutral position.
3. Remove the front floor console trim plate. Front Floor Console Trim Plate Replacement

4. Remove the upper shifter closeout boot from the lower closeout boot.
5. Remove the 4 fasteners (1) securing the shift control assembly to the tunnel reinforcement.

Fig 3: Shift Control Assembly Fasteners

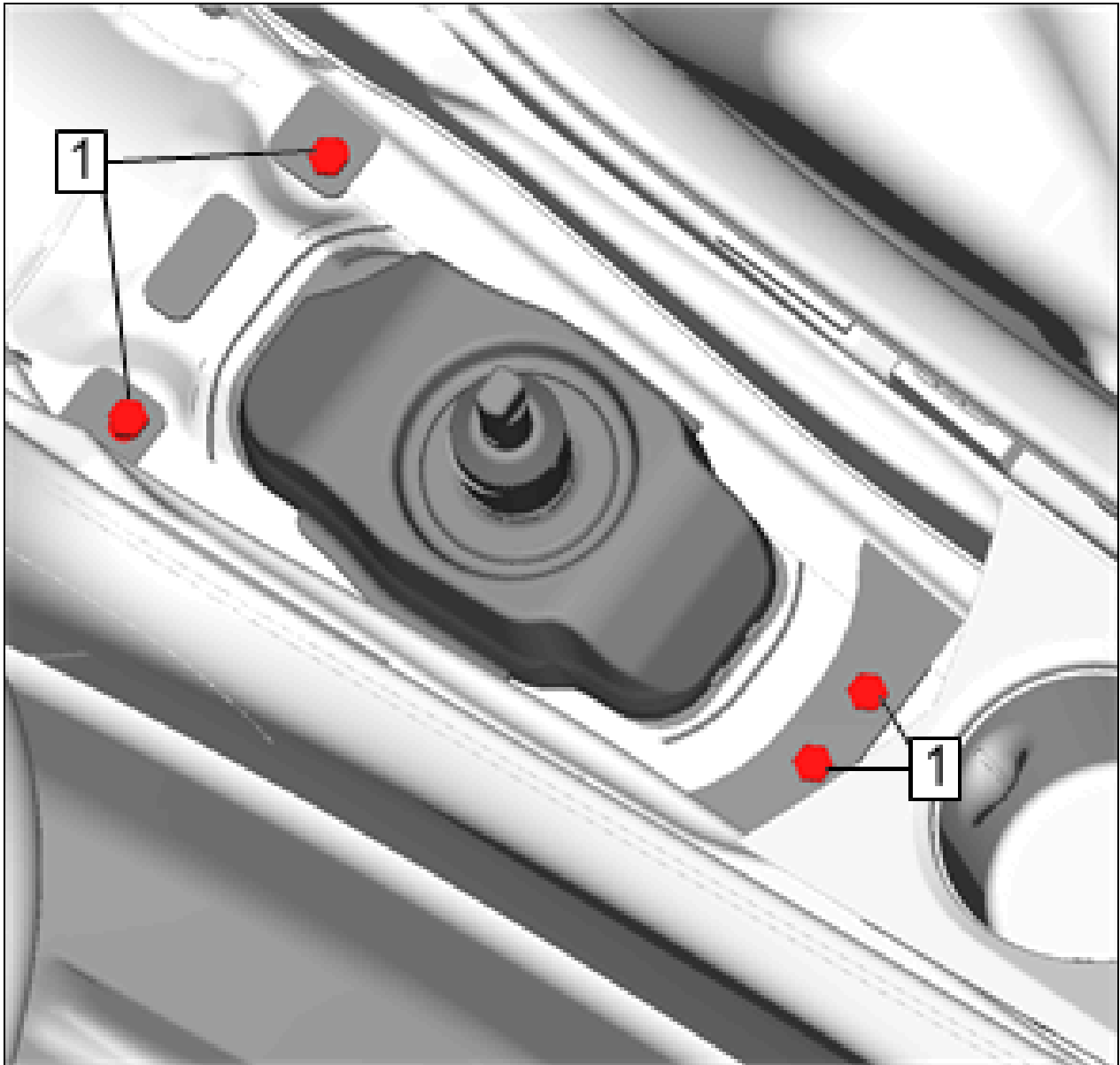

Courtesy of GENERAL MOTORS COMPANY

6. Push the tabs on the closeout boot (1) inward and down to clear the body structure.

Fig 4: Closeout Boot

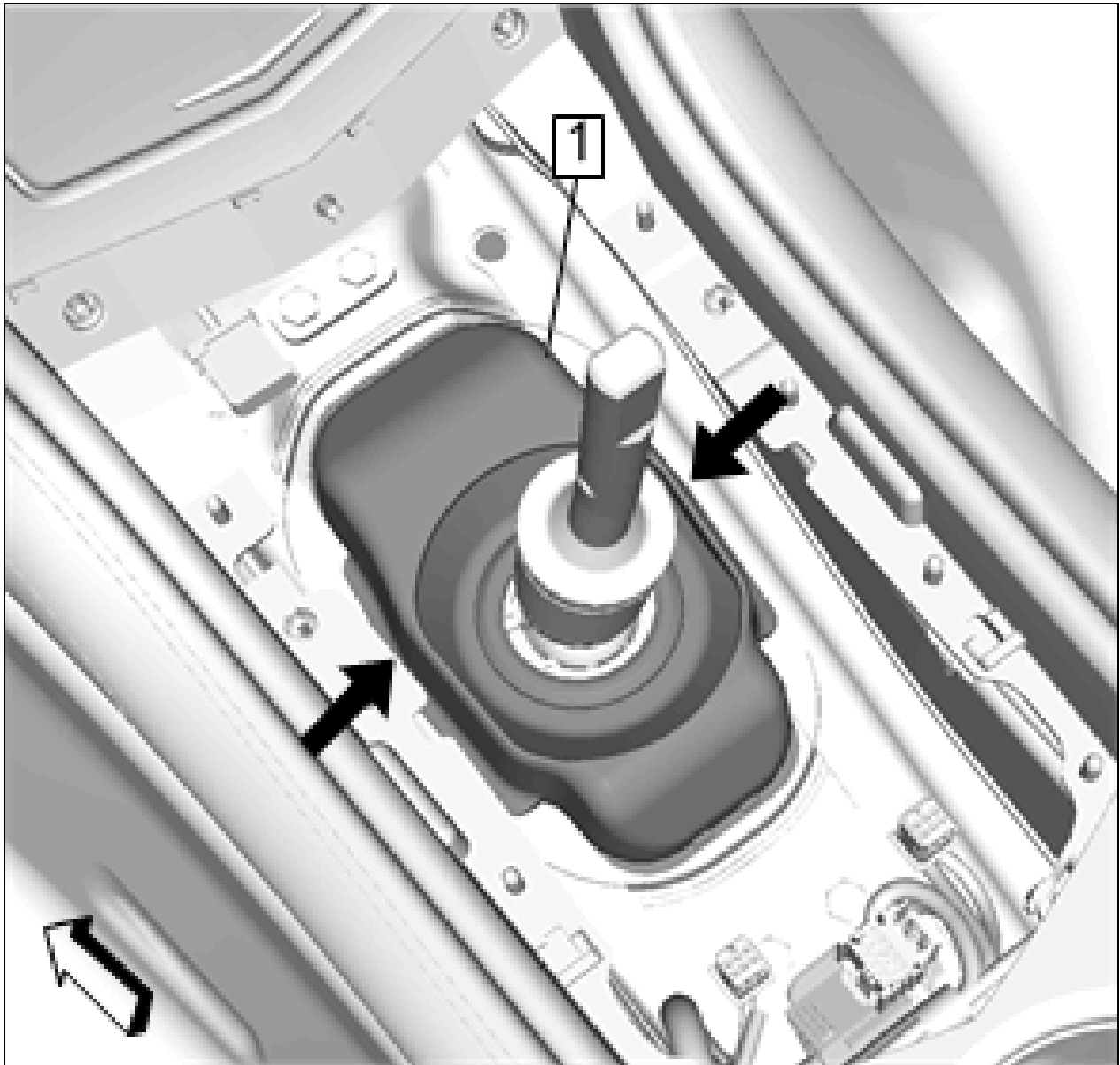

Courtesy of GENERAL MOTORS COMPANY

7. Raise the vehicle. Lifting and Jacking the Vehicle (Base)Lifting and Jacking the Vehicle (V-Series)
8. Remove the propeller shaft. Two-Piece Propeller Shaft Replacement (LTG, LGX, LCV)Two-Piece Propeller Shaft Replacement (LF4)
9. Remove the shift linkage retaining clip (1).

Fig 5: Shift Linkage Pin

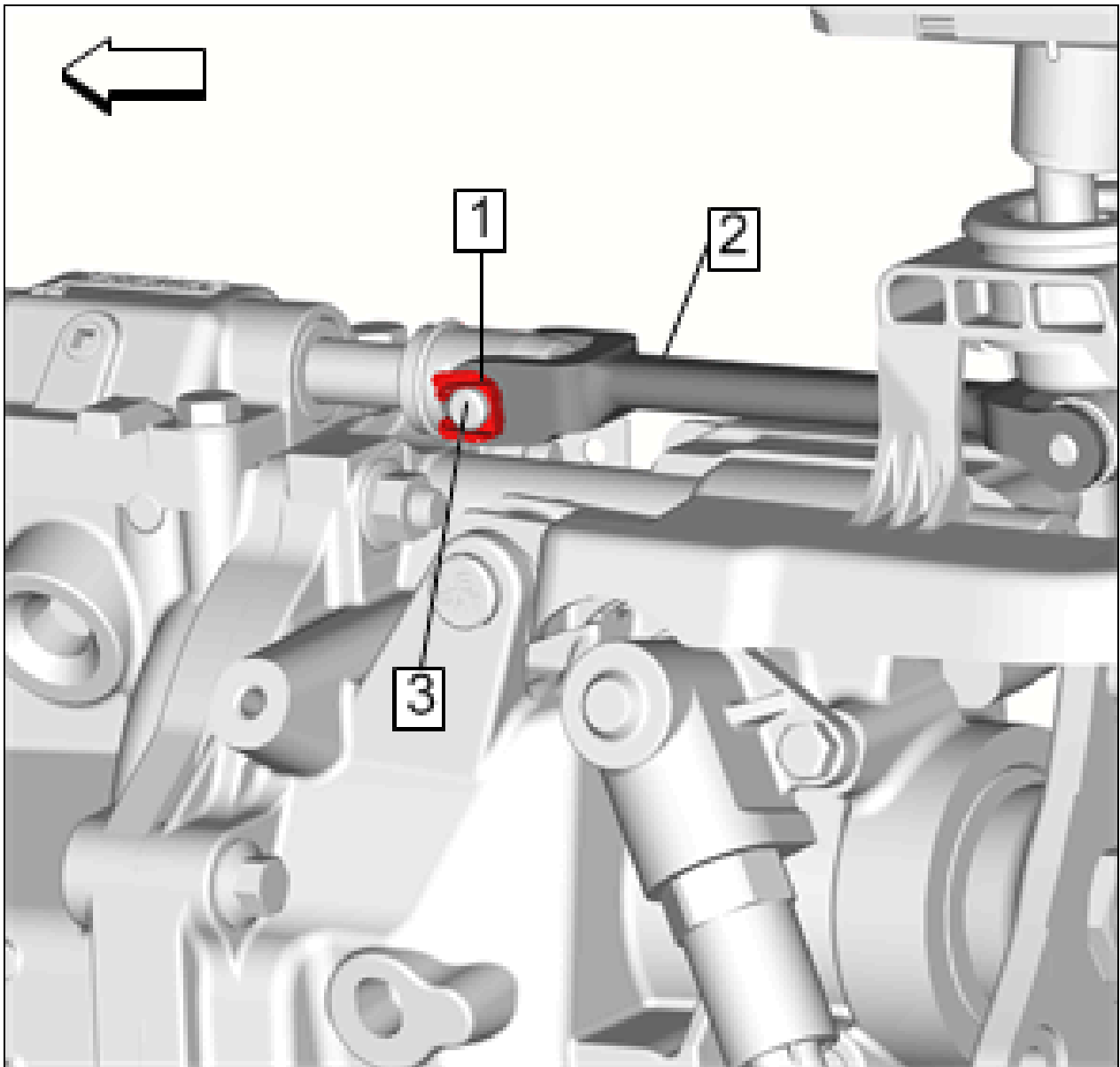

Courtesy of GENERAL MOTORS COMPANY

10. Remove the shift linkage pin (3).
11. Support the transmission with a suitable jack.
12. Remove the 4 fasteners (2) securing the transmission support. Transmission Support Replacement (Automatic RWD)Transmission Support Replacement (Automatic AWD)Transmission Support Replacement (Manual)

Fig 6: Identifying Transmission Support Fasteners

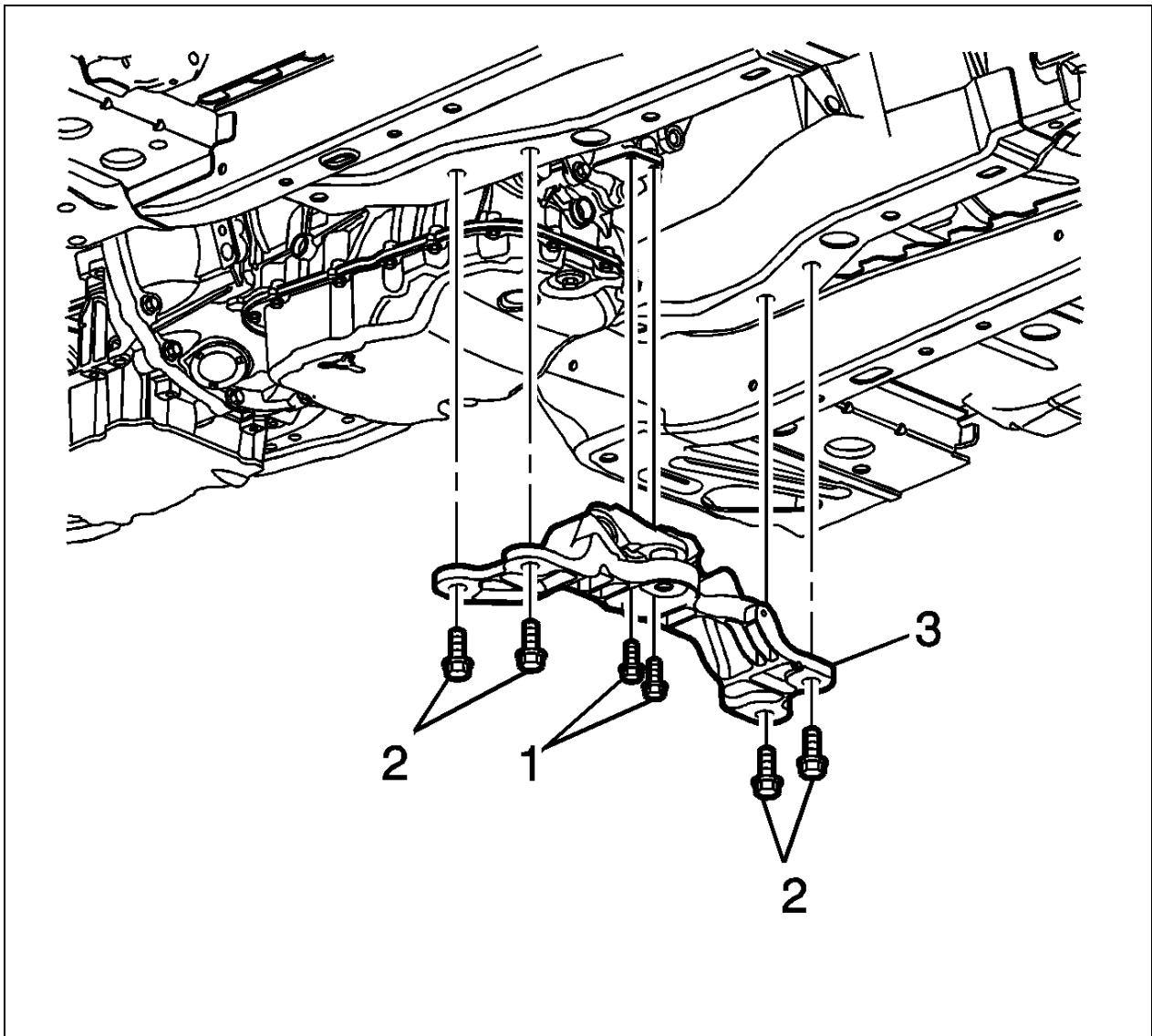

Courtesy of GENERAL MOTORS COMPANY

13. Lower the transmission assembly to gain access to the top of the transmission.
14. Using a suitable flat-blade tool, release the left side shift control rod pin retaining tab (1), while sliding the pin outward. The pin will lock again at the outer transmission boss (3). Using a suitable flat-blade tool, insert the tool between the boss (3) and the rubber mount on the shift control assembly to release the shift control rod pin retaining tab to slide it further out of the transmission boss. Reposition the transmission slightly to allow extra clearance to completely remove the pin.

Fig 7: Transmission Boss, Shift Control Rod Pin & Retaining Tab

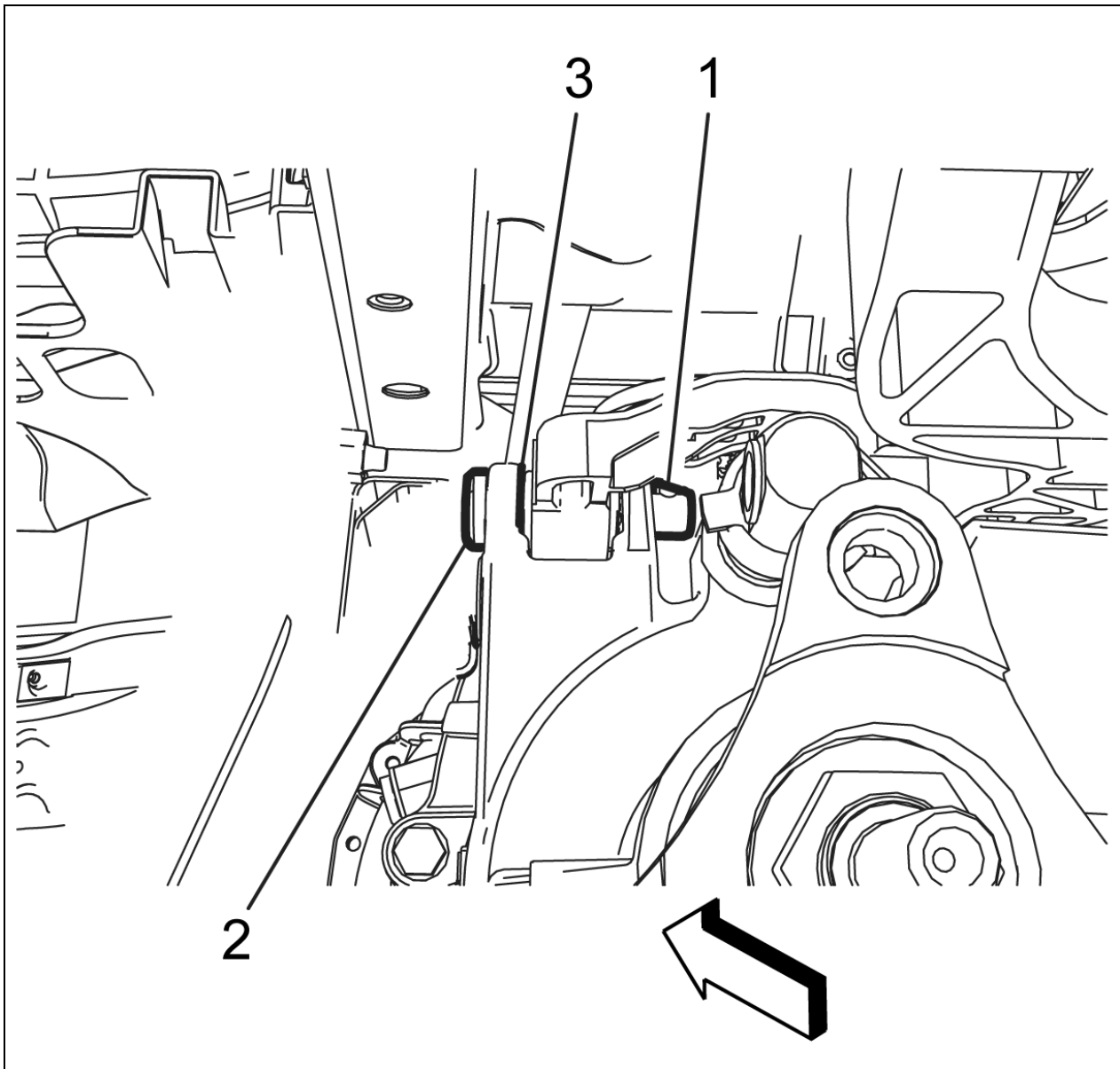

Courtesy of GENERAL MOTORS COMPANY

15. Using a suitable flat-blade tool, release the right side shift control rod pin retaining tab (1), while sliding the pin outward. The pin will lock again at the outer transmission boss. Using a suitable flat-blade tool, insert the tool between the boss and the rubber mount on the shift control assembly to release the shift control rod pin retaining tab to slide it further out of the transmission boss. Reposition the transmission slightly to allow extra clearance to completely remove the pin.

Fig 8: Right Side Shift Control Rod Pin Retaining Tab

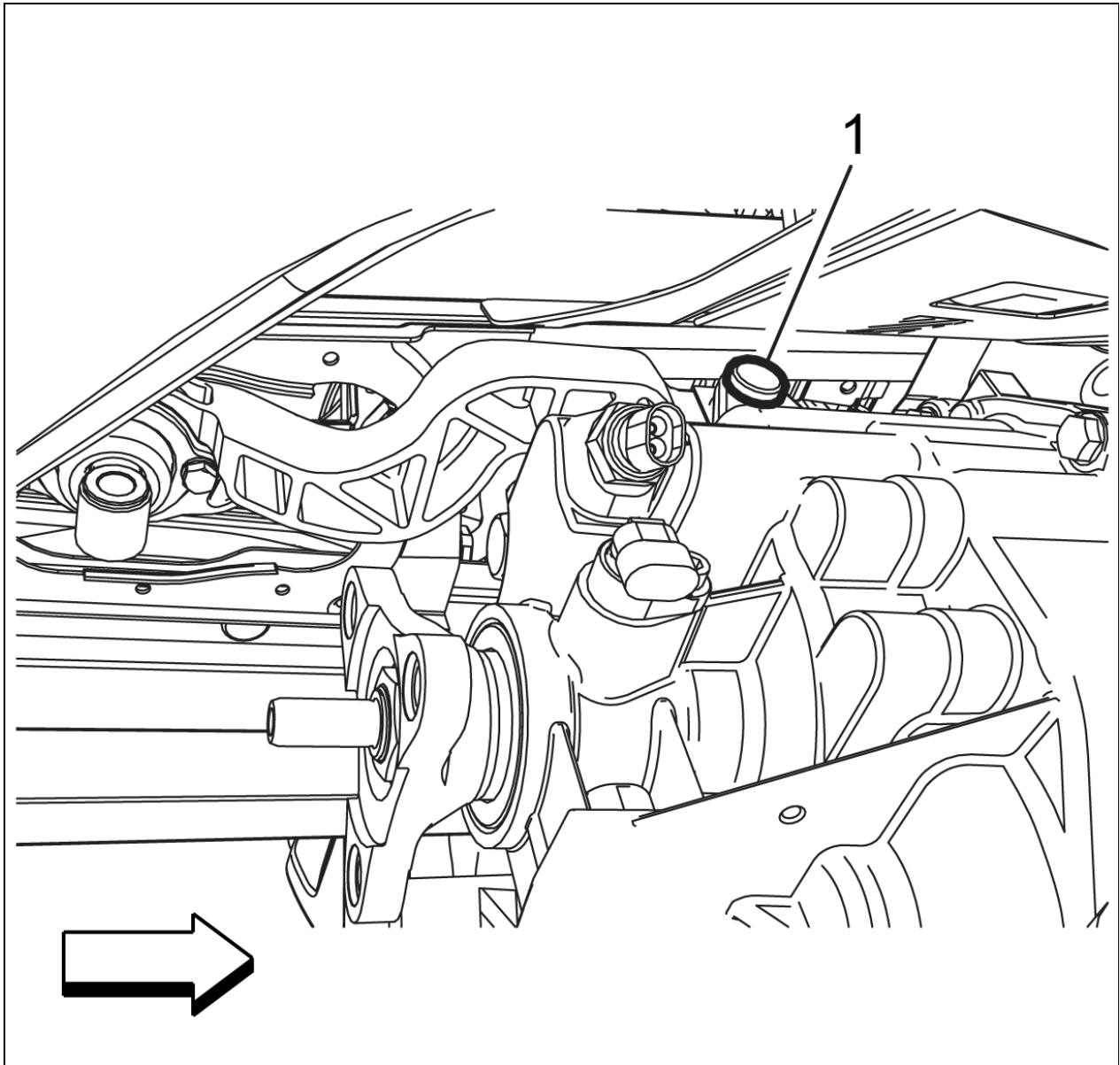

Courtesy of GENERAL MOTORS COMPANY

16. Loosen the two lower fasteners (1) on the shift control assembly enough to allow the removal of the shift control assembly.

Fig 9: Shift Control Assembly Lower Fasteners

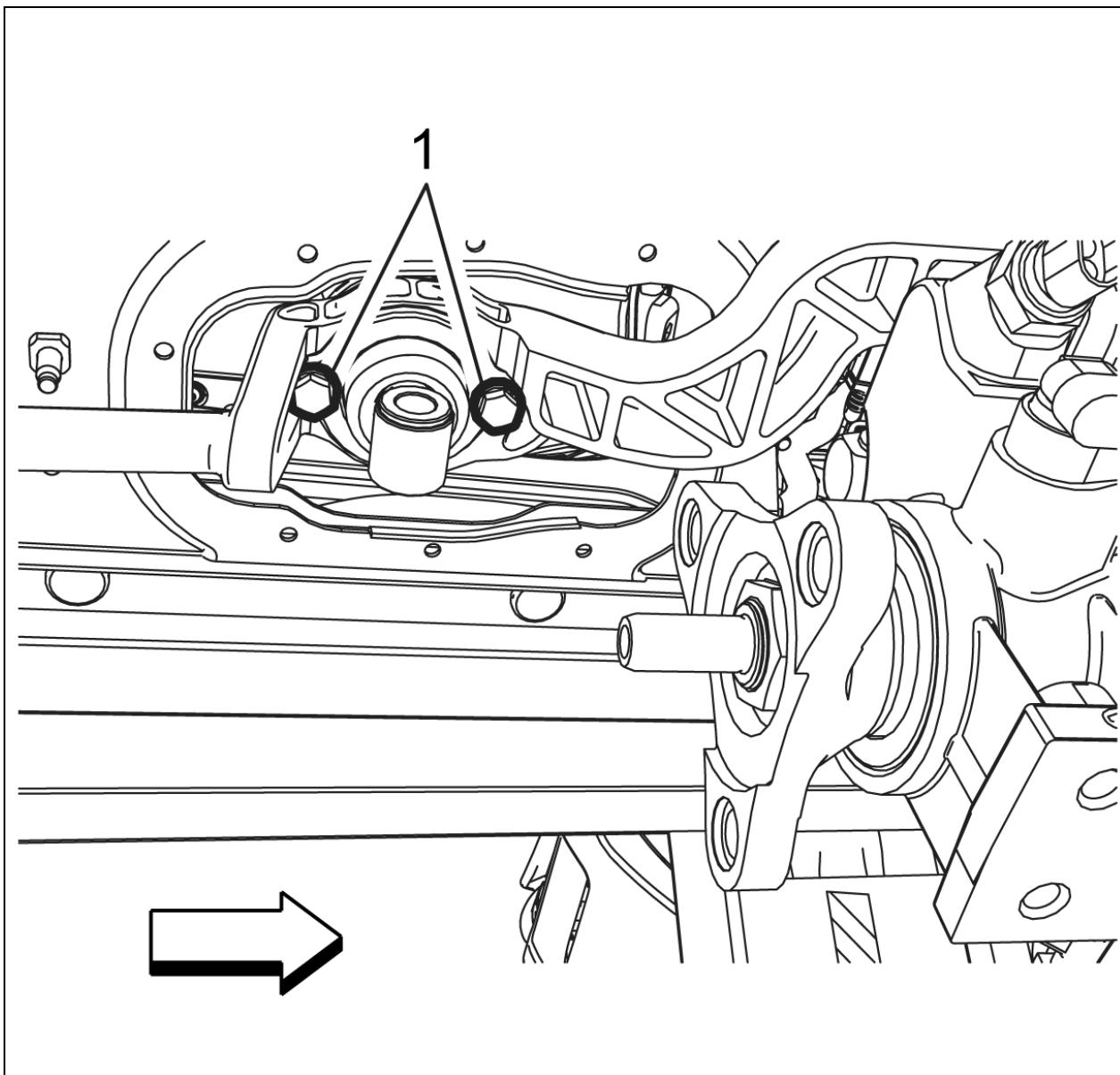

Courtesy of GENERAL MOTORS COMPANY

17. Remove the shift control assembly from the transmission.

Installation Procedure

1. Install the shift control assembly to the transmission.

NOTE: Before installing the shifter, ensure that the shift shaft it is clean of dirt or lubricants.

2. Install the right shift control assembly rod pin (1).

Fig 10: Right Side Shift Control Rod Pin Retaining Tab

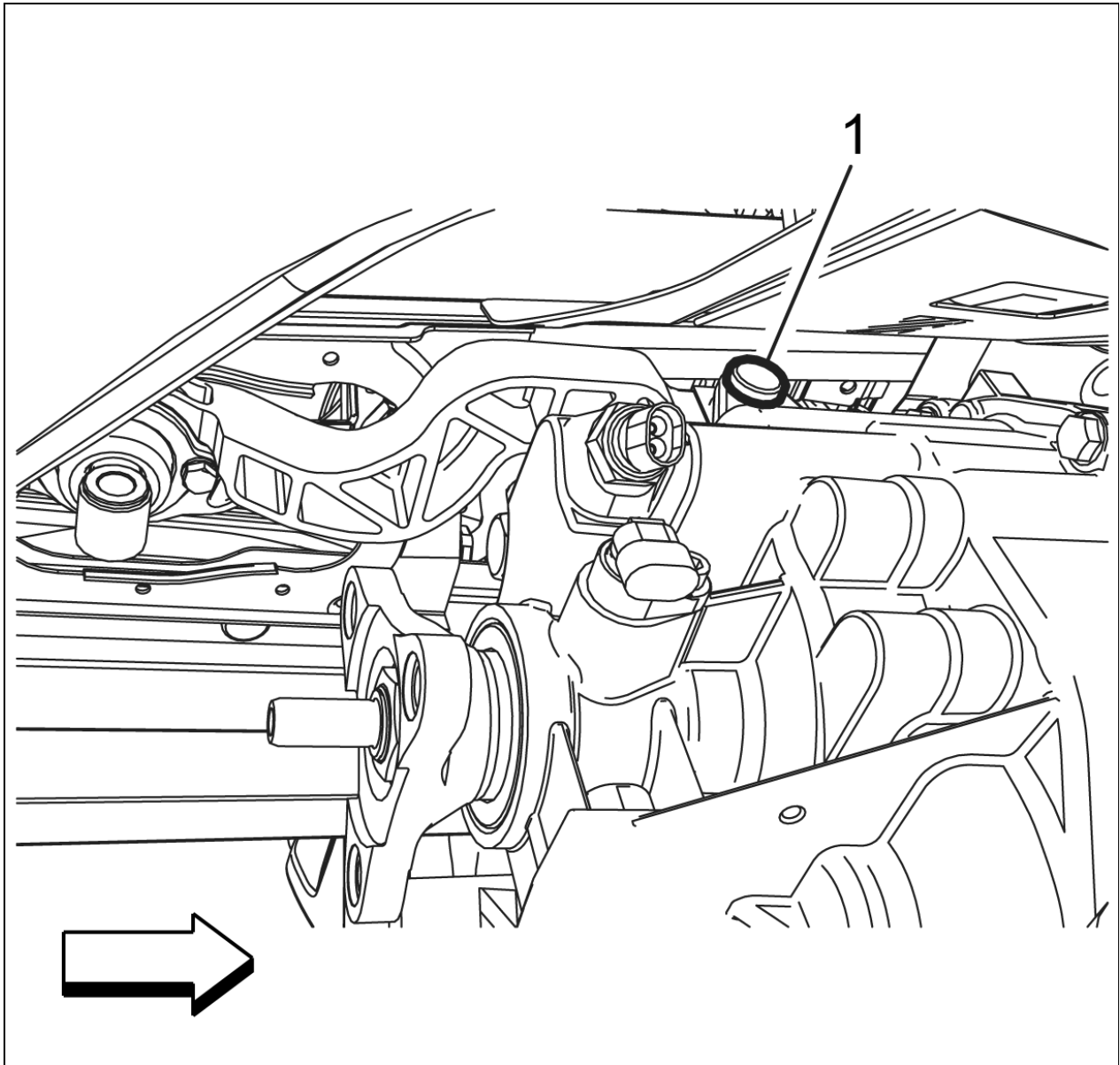

Courtesy of GENERAL MOTORS COMPANY

3. Install the left shift control assembly rod pin (2).

Fig 11: Transmission Boss, Shift Control Rod Pin & Retaining Tab

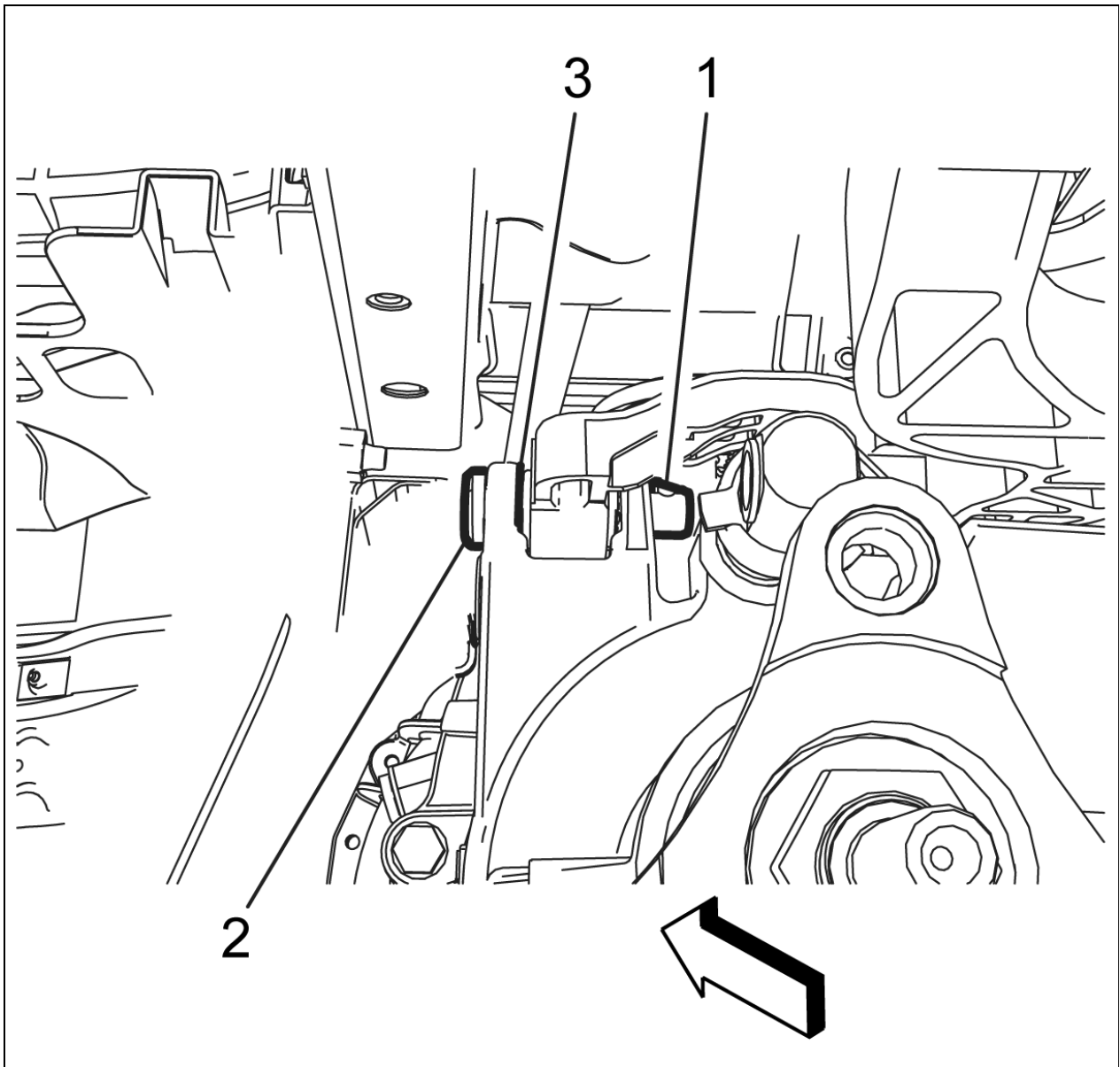

Courtesy of GENERAL MOTORS COMPANY

CAUTION: Refer to Fastener Caution .

4. Tighten the two lower fasteners (1) on the shift control assembly to 18 N.m (13 lb ft)

Fig 12: Shift Control Assembly Lower Fasteners

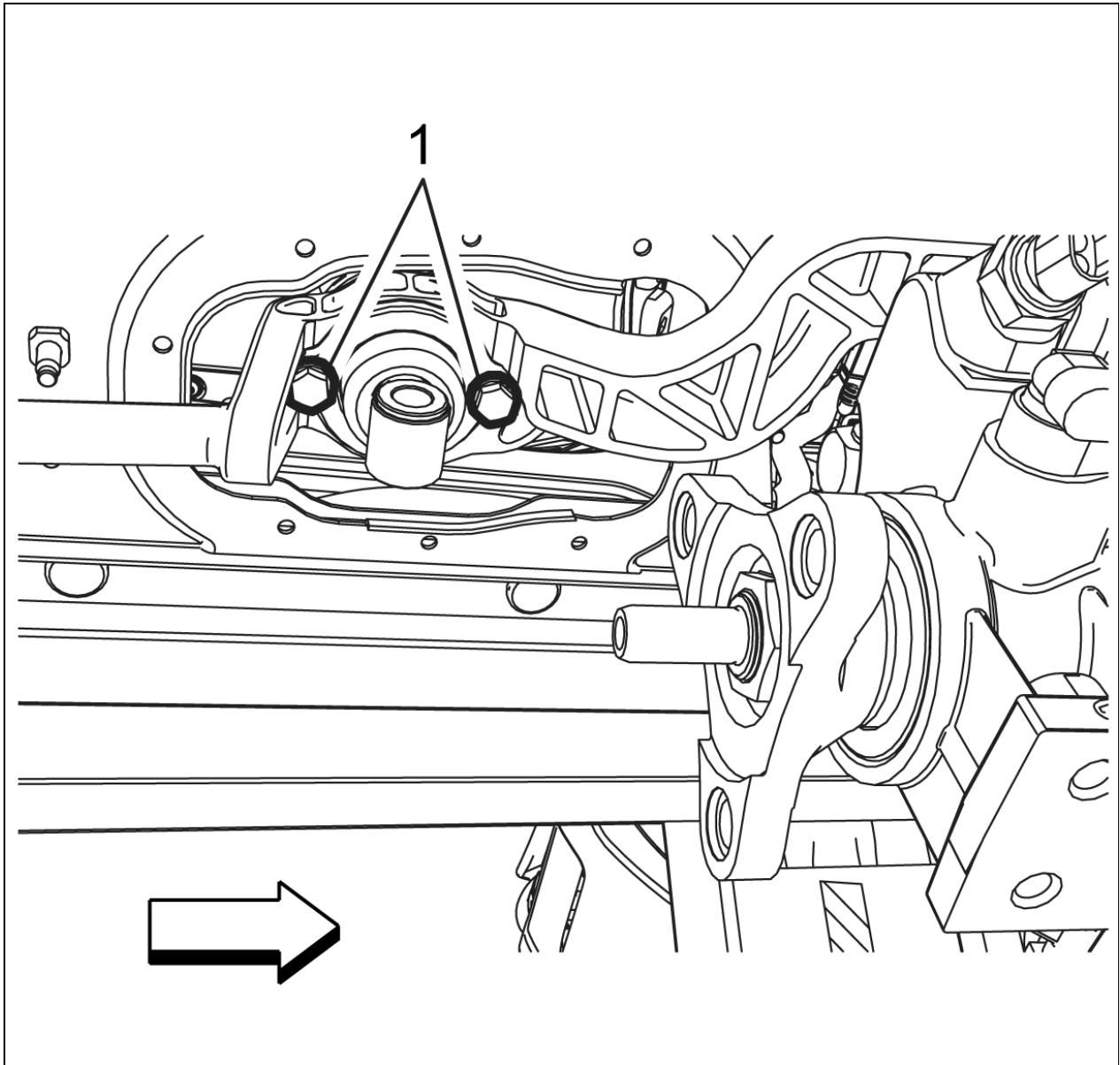

Courtesy of GENERAL MOTORS COMPANY

5. Install the shift linkage pin (3).

Fig 13: Shift Linkage Pin

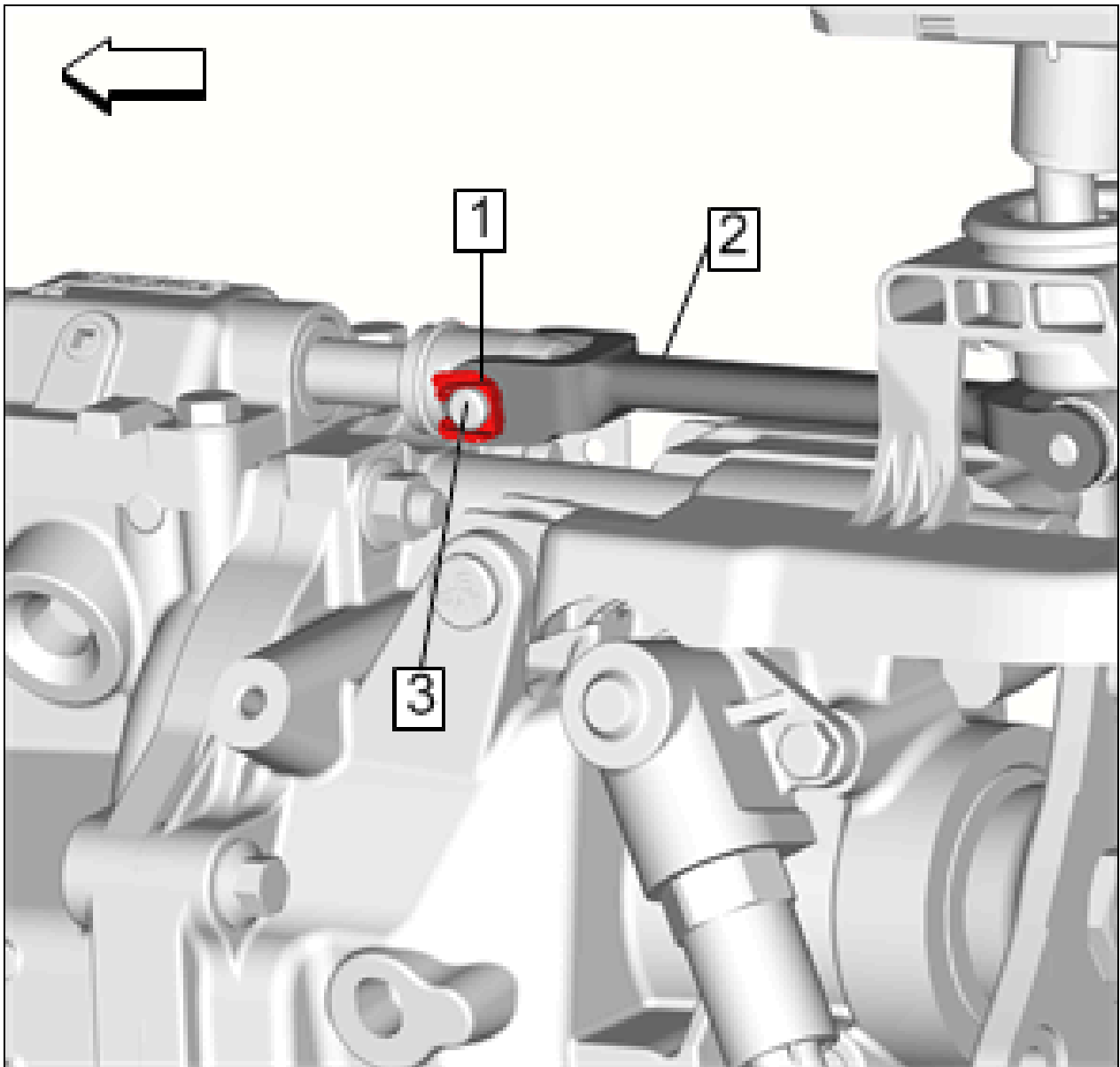

Courtesy of GENERAL MOTORS COMPANY

6. Install the shift linkage retaining clip (1).
7. Raise the transmission.

Fig 14: Identifying Transmission Support Fasteners

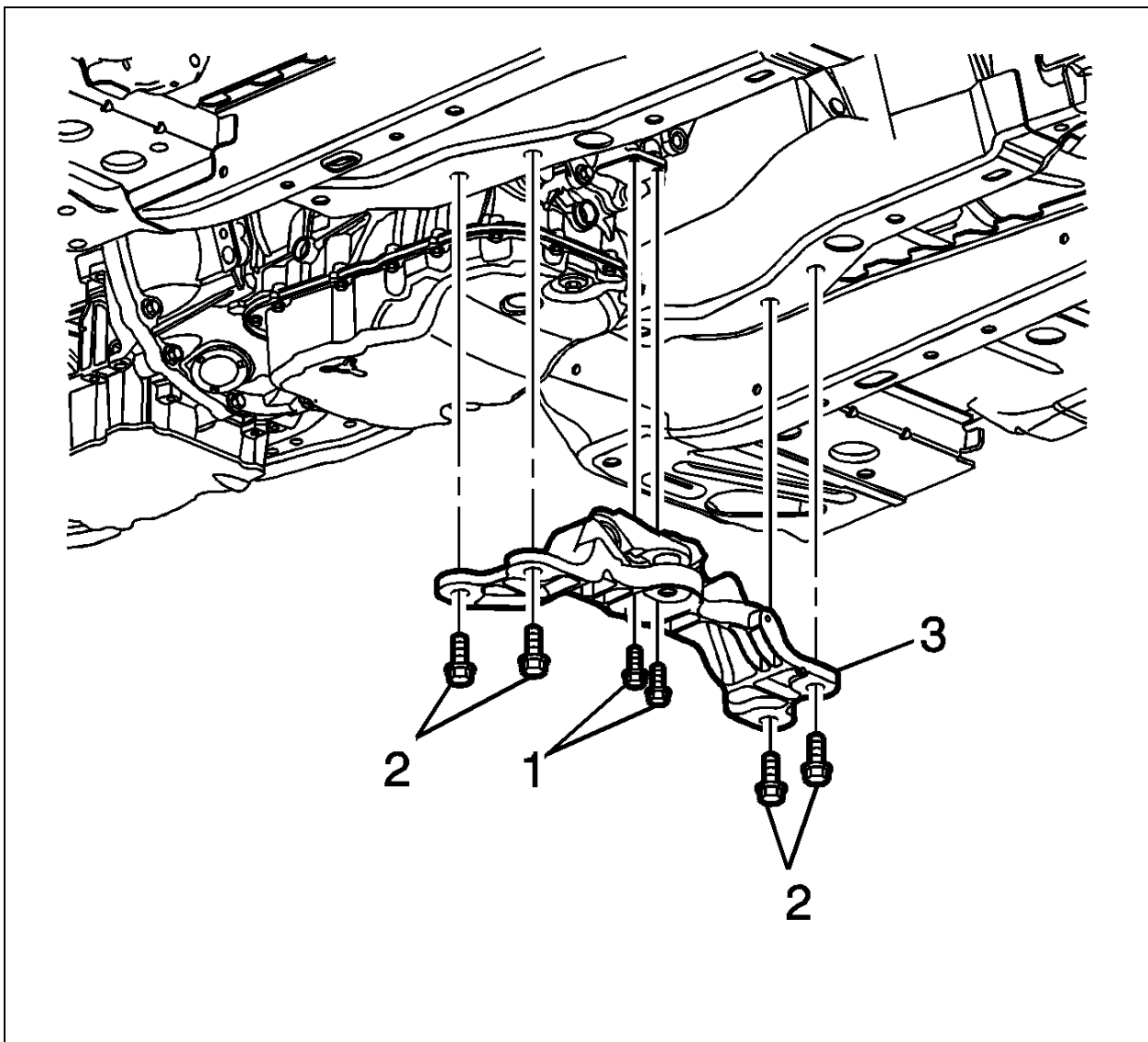

Courtesy of GENERAL MOTORS COMPANY

8. Install the 4 transmission support fasteners (2), then tighten to 60 N.m (44 lb ft).
9. Remove the jack supporting the transmission.
10. Install the propeller shaft. Two-Piece Propeller Shaft Replacement (LTG, LGX, LCV)Two-Piece Propeller Shaft Replacement (LF4)
11. Lower the vehicle.
12. Pull up and outward on the tabs on the closeout boot (1) to clear the body structure.

Fig 15: Closeout Boot

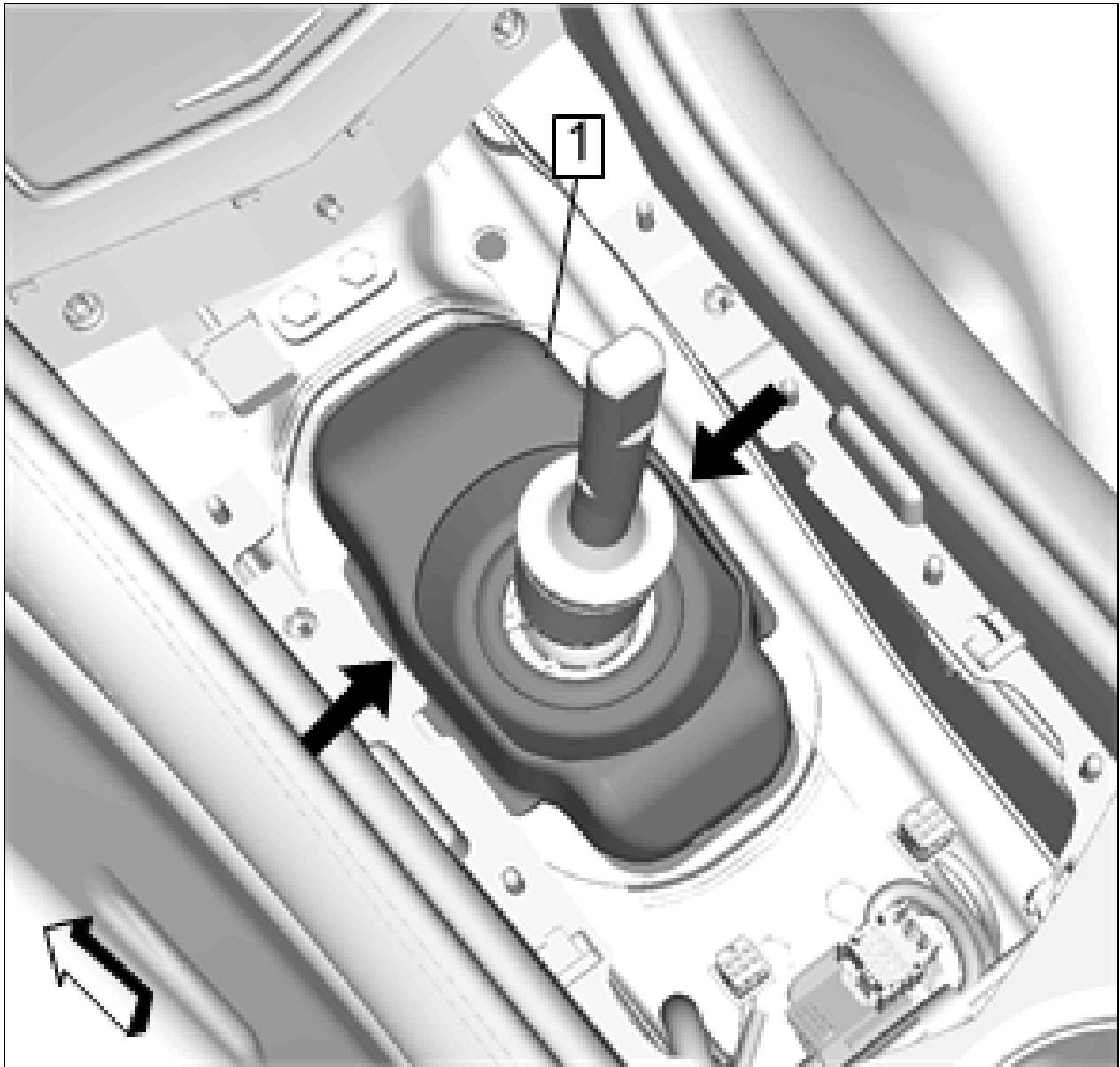

Courtesy of GENERAL MOTORS COMPANY

13. Install the 4 fasteners (1) securing the shift control assembly to the tunnel reinforcement, then tighten to 12 N.m (106 lb in)

Fig 16: Shift Control Assembly Fasteners

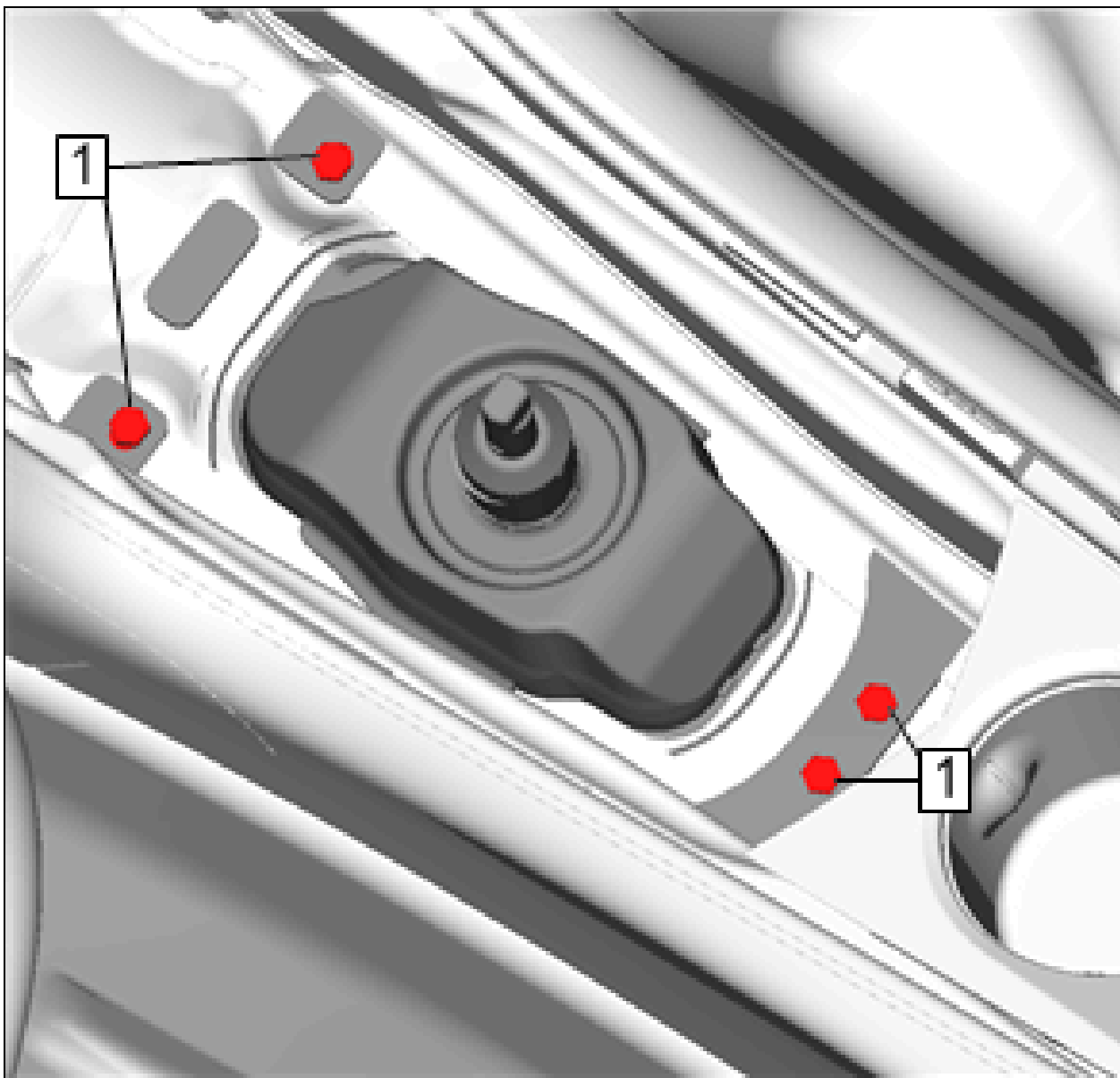

Courtesy of GENERAL MOTORS COMPANY

14. Install the upper shifter closeout boot to the lower closeout boot.

NOTE: *Ensure the directional arrow on the boot in installed pointing to the front of the vehicle. If it is installed backwards it will create a squeak.*

15. Install the front floor console trim plate. Front Floor Console Trim Plate Replacement
16. Install the shift control knob (1). Transmission Control Lever Knob Replacement

Fig 17: Transmission Control Lever Boot

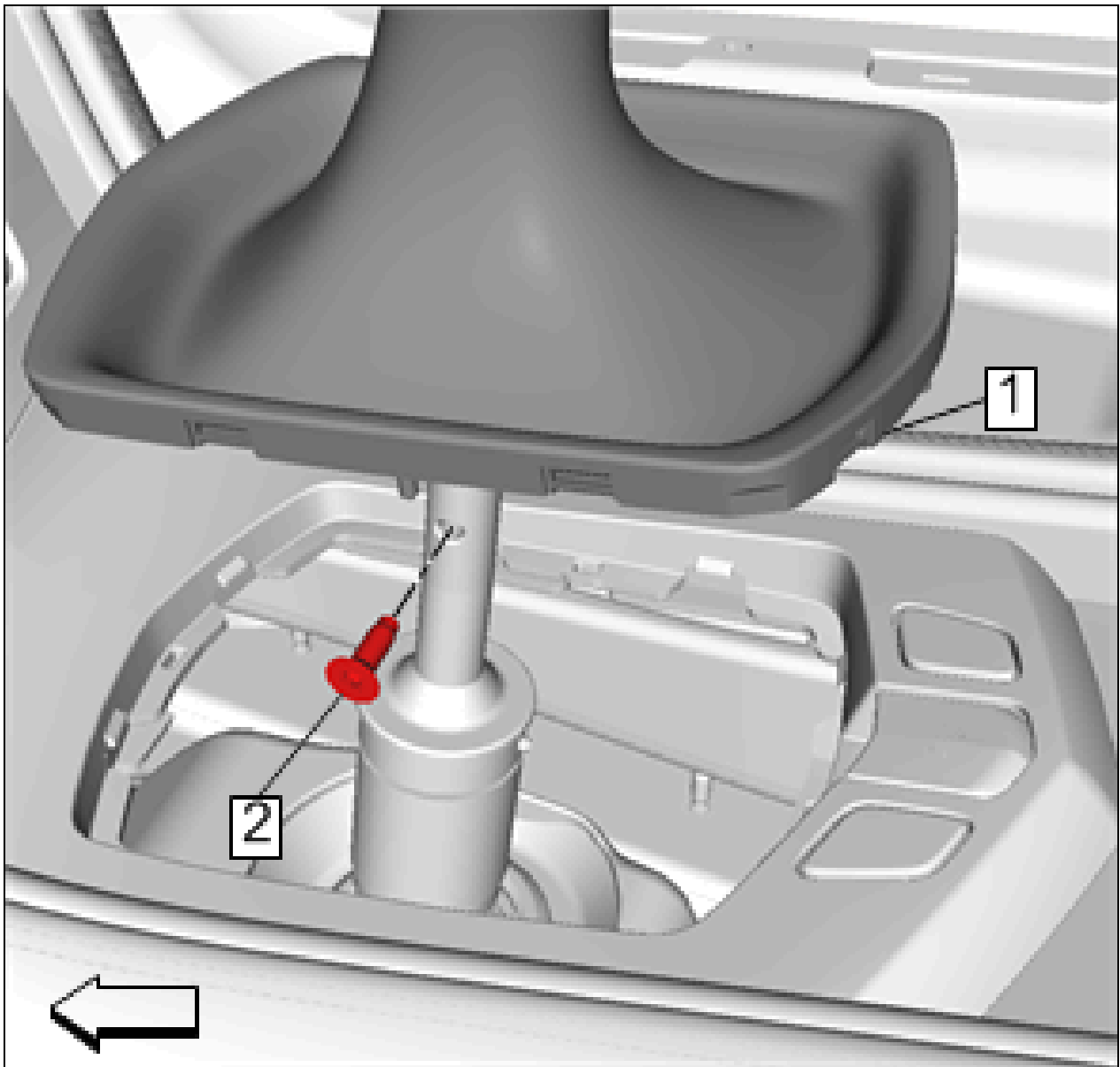

Courtesy of GENERAL MOTORS COMPANY

17. Perform the gear position relearn. Gear Position Sensor Learn